

ITEM NO.	DESCRIPTION	POWER CORD NO.	BOTTOM PLATE NO.	TOP LEFT PLATE NO.	TOP RIGHT PLATE NO.
PSG4-DG208240	DBL SANDW GRILL-GRVED 208-240V	354097-1	352742-22-1	352743-22-1	352743-24-1
PSG4-DG208240-C	DBL SND GRIL-GRVED 208-240V CA	354098-1	352742-22-1	352743-22-1	352743-24-1
PSG4-DF208240	DBL SNDWCH GRILL-FLAT 208-240V	354097-1	352742-21-1	352743-21-1	352743-23-1
PSG4-DF208240-C	DBL SND GRILL-FLAT 208-240V CA	354098-1	352742-21-1	352743-21-1	352743-23-1

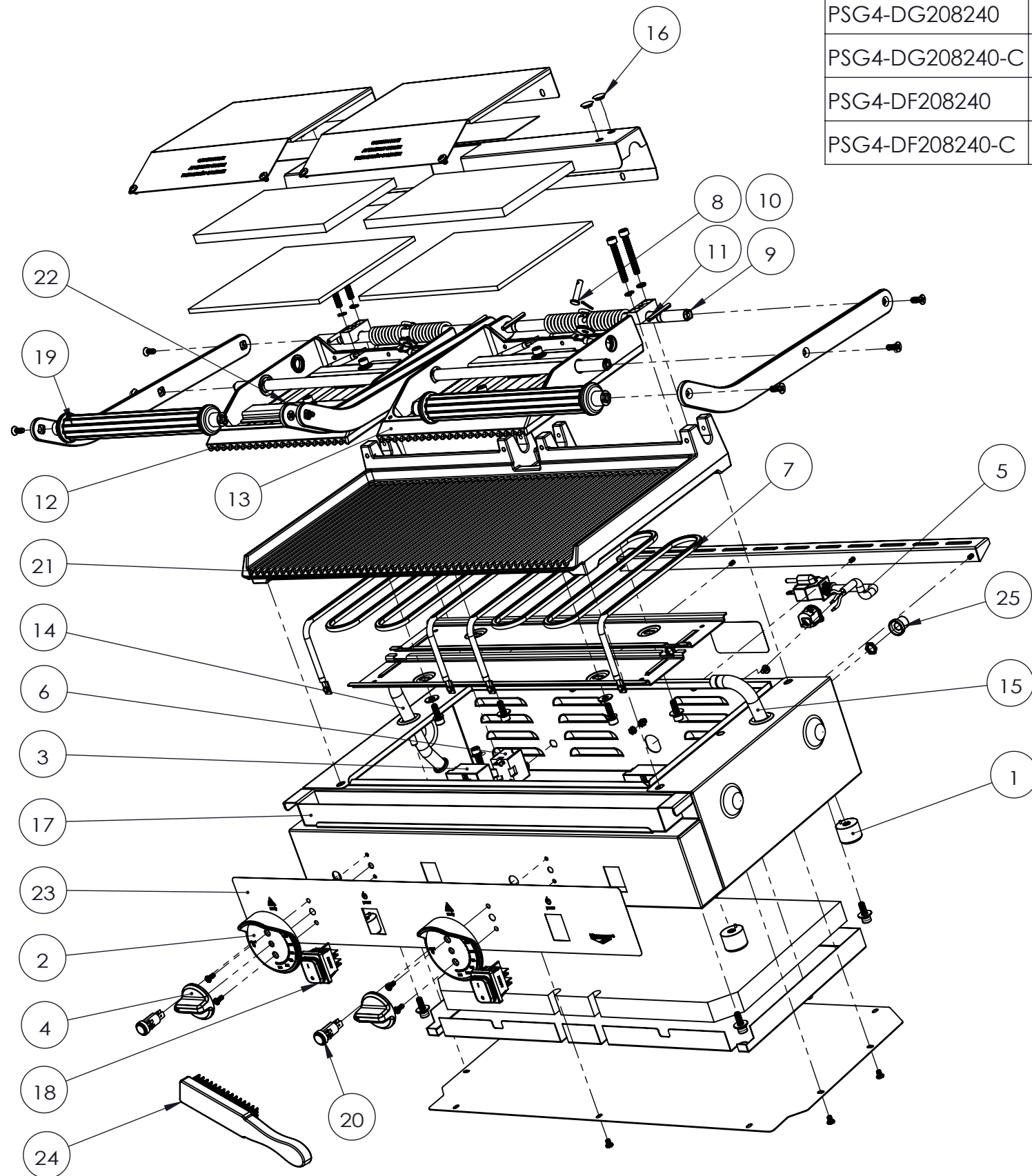

25	351788-03-1	HIGH LIMIT THERMOSTAT COVER	2
24	352760	WIRE BRUSH	1
23	352742-01-1	DHP OVERLAY	1
22	352752-1	DHP TOP HEATING ELEMENT	2
21	SEE CHART	BOTTOM PLATE	1
20	351788-18-1	240V PILOT LIGHT	2
19	354093-1	DHP HANDLE KIT	2
18	352774-1	RECT POWER SWITCH 240V DPST	2
17	352742-07-1	DHP DRIP TRAY	1
16	352764-1	TENSIONER SILICONE PLUG	4
15	352757-1	RIGHT WIRE TUBE	1
14	352758-1	LEFT WIRE TUBE	1
13	SEE CHART	TOP RIGHT PLATE	1
12	SEE CHART	TOP LEFT PLATE	1
11	352759-1	TENSIONER	2
10	352775-1	M6X25 PIN	2
9	352742-09-1	DHP HINGE AXLE BACK	2
8	352761-1	HANDLE SPRING	2
7	352744-1	DHP BTM HEATING ELEMENT	2
6	352751-1	350C HIGH LIMIT THERMOSTAT	2
5	SEE CHART	POWER CORD / STRAIN RELIEF KIT	1
4	351788-06-1	CONTROL KNOB	2
3	352750-1	300C REGULATING THERMOSTAT	2
2	354194-1	SHP/DHP PANINI BEZEL & OVERLAY	2
1	351775-1	KIT, FOOT, 1.00" OD, 20MM LG, QTY 4	1
SN	PART NO.	DESCRIPTION	QTY.